

HyDra 45

- ✓ **Easy and fast assembling in 5 clicks only and in less than 30 seconds**
- ✓ **No tools needed**
- ✓ **Exclusive design patented by Fte maximal**
- ✓ **Fixed to the mast with bridle and reinforced clamps**
- ✓ **Savings in storage space and transport**

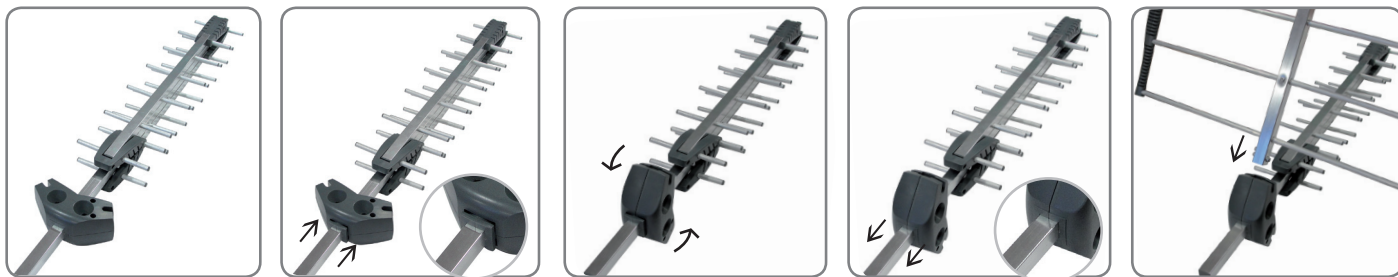

**Optimization of the packaging system** with savings in the space and size in the transport and in storage too, thanks to our exclusive and patented system in which the base turns 90° reducing the package size up to 25%\*.



\* Comparative made with EVO series

### Intuitive system and fast assembly

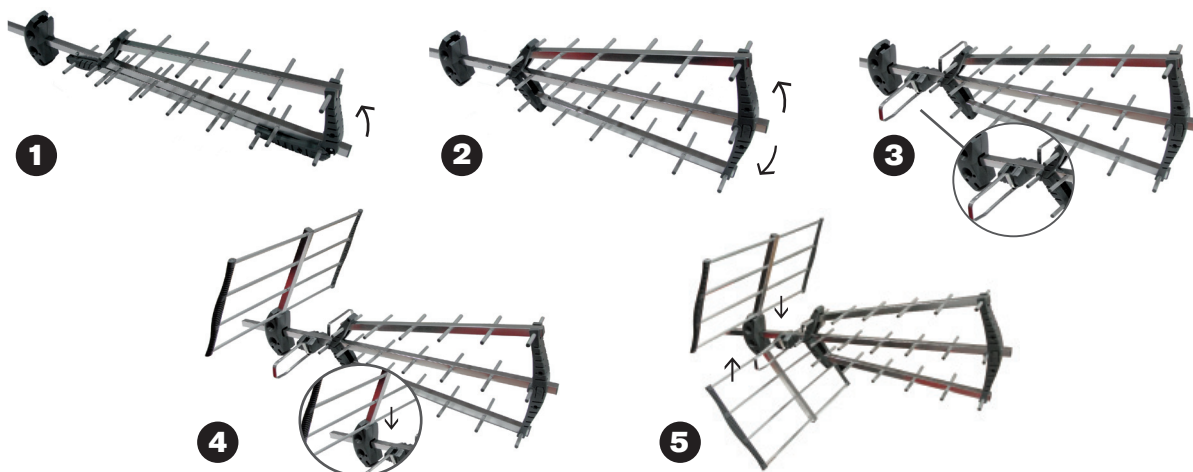

## Technical Features

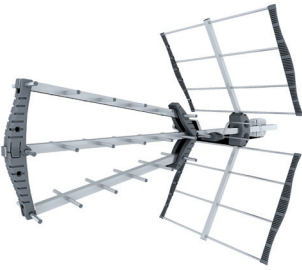
|  | Reference | Code    | Features   |
|---|-----------|---------|--|
|   | HyDra 35  | 9003930 | 20 elements<br>Channel: 21-69<br>Gain: 15 dB<br>Front/Back relation (f/b): 24 dB<br>Horizontal reception angle (-3 dB): 35°<br>Impedance: 75 Ohms<br>Length: 810 mm<br>Weight of the antenna: 1,5 Kg |

## Packaging solutions

| Reference  | Packaging | Measures (mm) |     |     | Volume (cm³) | Weight (Kg) | EAN 13        |
|--|-----------|---------------|-----|-----|--------------|-------------|---------------|
| HyDra 35*<br>(9003930)                                       | Box 1/2   | 880           | 135 | 70  | 8.316        | 1,3         | 8436049496122 |
|  | Box 2/2   | 535           | 320 | 40  | 6.848        | 0,625       |               |
| * Presentation in one unit boxes. It is composed by 2 boxes. |           |               |     |     |              |             |               |
| HyDra 35/12*<br>(9003930/12)                                 | Master    | 1.000         | 580 | 300 | 226.200      | 25,6        | 8436049496146 |
| * Presentation in master box with 12 units.                  |           |               |     |     |              |             |               |

## Technical Features

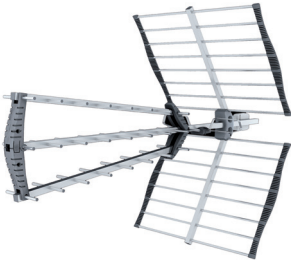
|  | Reference | Code    | Features   |
|---|-----------|---------|--|
|   | HyDra 45  | 9003932 | 26 elements<br>Channel: 21-69<br>Gain: 17 dB<br>Front to Back Ratio (f/b): 28 dB<br>Horizontal reception angle (-3 dB): 32°<br>Impedance: 75 Ohms<br>Length: 1.020 mm<br>Weight of the antenna: 1,8 Kg |

## Packaging solutions

| Reference  | Packaging | Measures (mm) |     |     | Volume (cm³) | Weight (Kg) | EAN 13        |
|--|-----------|---------------|-----|-----|--------------|-------------|---------------|
| HyDra 45*<br>(9003932)                                       | Box 1/2   | 1060          | 135 | 70  | 10.017       | 1,5         | 8436049496139 |
|  | Box 2/2   | 550           | 430 | 40  | 9.460        | 0,965       |               |
| * Presentation in one unit boxes. It is composed by 2 boxes. |           |               |     |     |              |             |               |
| HyDra 45/6*<br>(9003932/6)                                   | Master    | 1.120         | 440 | 285 | 140.448      | 16,0        | 8436049496153 |
| * Presentation in master box with 12 units.                  |           |               |     |     |              |             |               |